

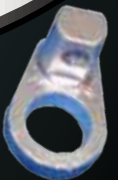

Reliable Solutions and Porosity-Free Products

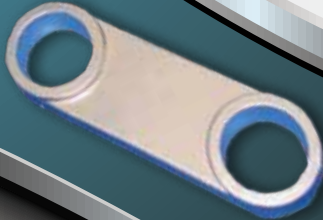

Verisys
Registrars
ISO 9001:2008
Certified

Battery Terminals

with a **POSITIVE** difference



Table of Contents

About Us.....	Page 2
Molded Terminals.....	Pages 3-4
Burn On Terminals.....	Pages 5-10
Industrial Connectors & Components.....	Pages 11-23
Industrial Battery Cable Assemblies.....	Page 24

About Us

For over 40 years, Centrifugal Castings has been a leading supplier to the battery industry. Centrifugal has developed a large catalog of products including "molded in" and "burn on" battery terminals, industrial connectors and other battery components.

Our proprietary manufacturing process produces porosity free battery terminals and components that deliver better conductivity, longer life, safer installation and higher torque. We're also ISO 9001:2008 certified.

Have a new part requirement or modification to an existing part? From design to prototyping, through production, Centrifugal will make the process seamless and cost effective. No need to wait months and incur tens of thousands of dollars in development! Centrifugal can take your drawing into production in a matter of weeks for far less start-up costs.

With the challenges of labor shortages and rising wages and costs in today's market, why not outsource your internal terminal and component work. Many of our customers have found it cost effective, more productive and free up valuable manufacturing space to have Centrifugal handle their internal part requirements. Leave it to Centrifugal to handle these parts so you can focus on what you do best, manufacturing quality batteries!

We look forward to the opportunity to partner with you. Centrifugal is proud of our continued commitment in providing quality products and top level service.

Sincerely,

Paul C. White
President

Part Number: 010-11-01
Description: Group 31 Universal Terminal 1.53"
Center to Center with 3/8-16 Bolt



Part Number: 011-11-01
Description: Group 31 Negative Terminal 1.53"
Center to Center with Standard SAE Post



Part Number: 012-11-01
Description: Group 31 Positive Terminal 1.53"
Center to Center with Standard SAE Post



Part Number: 013-11-01
Description: Dual Positive Terminal 1.20" Center to Center
with Standard SAE Post and 3/8-16 Bolt



Part Number: 016-11-01

Description: Dual Negative Terminal 1.20" Center to Center with Standard SAE Post and 5/16-18 Bolt



Part Number: 017-11-01

Description: Low Profile Universal Terminal 1.53" Center to Center with 5/16-18 Bolt



Part Number: 018-11-01

Description: Dual Positive Terminal 1.53" Center to Center with Standard SAE Post and 5/16-18 Bolt



Part Number: 019-11-01

Description: Dual Negative Terminal 1.53" Center to Center with Standard SAE Post and 5/16-18 Bolt



Part Number: 001-11-02
Description: Low Profile Universal Terminal
1" Center to Center with 5/16-18 Bolt



Part Number: 002-11-01
Description: High Profile Negative Terminal
1" Center to Center with Standard
SAE Post and 5/16-18 Bolt



Part Number: 003-11-01
Description: High Profile Positive Terminal
1" Center to Center with Standard
SAE Post and 5/16-18 Bolt



Part Number: 038-11-01
Description: Low Profile Positive Terminal
1" Center to Center with Standard
SAE Post and 5/16-18 Bolt



Part Number: 039-11-01

Description: Low Profile Negative Terminal
1" Center to Center with Standard
SAE Post and 5/16-18 Bolt



Part Number: 007-11-01

Description: Dual Negative Terminal
1" Center to Center with Standard
SAE Post and 5/16-18 Bolt



Part Number: 008-11-01

Description: Dual Positive Terminal
1" Center to Center with Standard
SAE Post and 5/16-18 Bolt



Part Number: 005-11-01

Description: Universal Positive Terminal with
Standard SAE Post and Offset 5/16" Hole



Part Number: 006-11-01

Description: Universal Negative Terminal with
Standard SAE Post and Offset 5/16" Hole



Part Number: 015-11-01

Description: Universal Burn on Terminal Post
1.12" Center to Center with 3/8-16 Bolt



Part Number: 081-11-01

Description: Offset 8D Terminal
1.25" Center to Center with 3/8-16 Bolt



Part Number: 082-11-01

Description: Offset 8D Terminal
1.25" Center to Center with 1/2-13 Bolt



Part Number: 091-11-01

Description: Combo Offset 8D Terminal
1.25" Center to Center with
5/16-18 Bolt and SAE Post



Part Number: 092-11-01

Description: Combo Offset 8D Terminal
1.25" Center to Center with
3/8-16 Bolt and SAE Post



Part Number: 024-11-01

Description: L Terminal with 3/8" Hole



Part Number: 036-11-01

Description: L Terminal with 3/8" Hole



Part Number: 105-15-01
Description: 3/8" Bolt Bus Positive Terminal



Part Number: 106-15-01
Description: 3/8" Bolt Bus Negative Terminal



Part Number: 109-15-01
Description: 1/2" Bolt Bus Positive Terminal



Part Number: 110-15-01
Description: 1/2" Bolt Bus Negative Terminal



Part Number: 031-11-01
Description: Lead Burning Stick 20 oz.



Part Number: 004-11-01
Description: Lead Boss 0.955 ID



Part Number: 004-11-02
Description: Lead Boss 0.700 ID



Part Number: 040-11-01
Description: 2-1/8" Intercell



Part Number: 041-11-01
Description: 2-3/4" Intercell



Part Number: 043-11-01
Description: 3" Intercell



Part Number: 042-11-01
Description: 3" Intercell Double for Fast Charge



Part Number: 044-11-01
Description: 3-1/8" Intercell



Part Number: 045-11-01
Description: 3-1/8" Intercell Double for Fast Charge



Part Number: 046-11-01
Description: 3-1/4" Intercell



Part Number: 048-11-01
Description: 3-1/2" Intercell



Part Number: 102-14-01

Description: 3-1/2" Intercell Double for Fast Charge



Part Number: 047-11-01

Description: 3-3/4" Solid Center Left

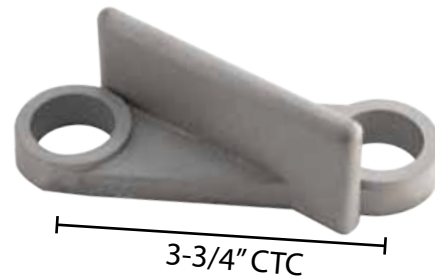

Part Number: 049-11-01

Description: 3-3/4" Solid Center Right



Part Number: 051-11-01

Description: 3-3/4" Intercell



Part Number: 050-11-01
Description: 3 Hole Flat End Intercell
3-3/4" Center to Center

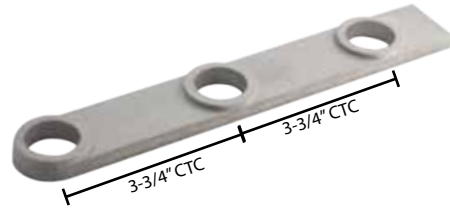

Part Number: 053-11-01
Description: 4-1/4" Intercell



Part Number: 054-11-01
Description: 4-1/2" Intercell



Part Number: 113-16-01
Description: 4-5/8" Intercell



Part Number: 055-11-01
Description: 4-3/4" Intercell



Part Number: 056-11-01
Description: 13 Plate 5" Intercell



Part Number: 057-11-01
Description: 5-1/4" Intercell



Part Number: 058-11-01
Description: 5-1/2" Intercell



Part Number: 114-16-01
Description: 5-5/8" Intercell

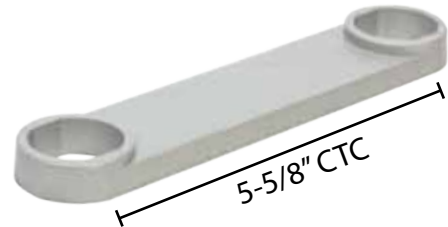

Part Number: 059-11-01
Description: 5-3/4" Intercell



Part Number: 060-11-01
Description: 6" Intercell



Part Number: 063-11-01
Description: 3 Hole Flat End Intercell
3-1/2" Center to Center



Part Number: 065-11-01
Description: 15 Plate Intercell
5-3/4" Center to Center



Part Number: 066-11-01
Description: 17 Plate 2 Hole Endrow
9-1/2" Center to Center



Part Number: 067-11-01
Description: 17 Plate 4 Hole Endrow
3" Center to Center

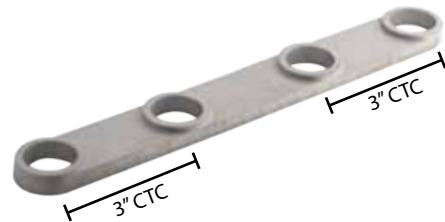

Part Number: 068-11-01
Description: 19 Plate 4 Hole Endrow
3" Center to Center

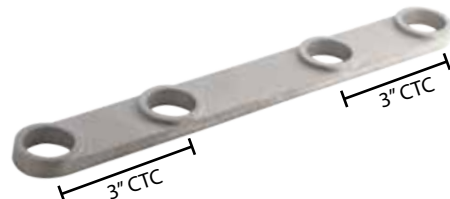

Part Number: 069-11-01
Description: 21 Plate 4 Hole Endrow
3-3/4" Center to Center



Part Number: 070-11-01
Description: 23 Plate 4 Hole Endrow
3-3/4" Center to Center

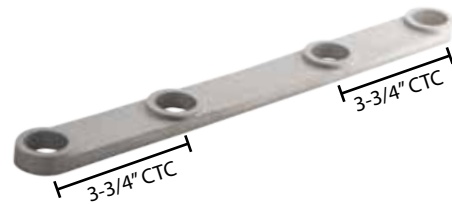

Part Number: 071-11-01
Description: 25 Plate 4 Hole Endrow
3-3/4" Center to Center

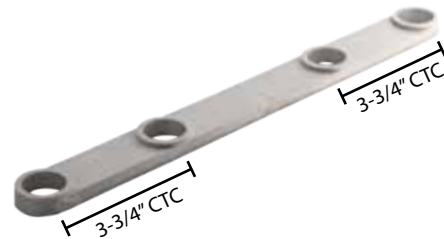

Part Number: 072-11-01
Description: 27 Plate 4 Hole Endrow
3-3/4" Center to Center

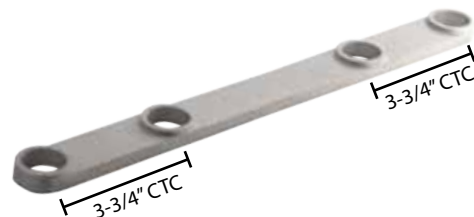

Part Number: 093-12-01
Description: 4D Terminal with 5/16" Insert



Part Number: 094-12-01
Description: Right 1 Hole with 3/8-16 Bolts(2)
1-3/4" Center to Center



Part Number: 095-12-01
Description: Left 1 Hole with 3/8-16 Bolts(2)
1-3/4" Center to Center



Part Number: 133-18-01
Description: Left 3" with 3/8-16 Bolts(2)
1" Center to Center

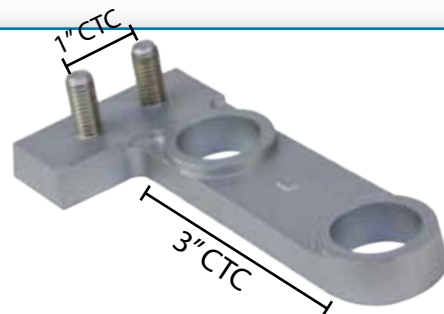

Part Number: 134-18-01
Description: Right 3" with 3/8-16 Bolts(2)
1" Center to Center

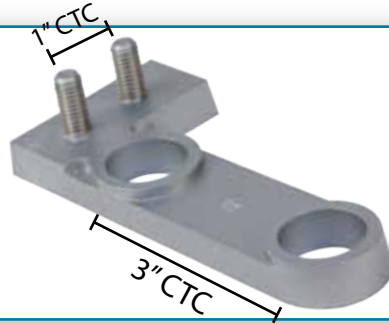

Part Number: 028-11-01
Description: Left 3" with 3/8-16 Bolts(2)
1-3/4" Center to Center

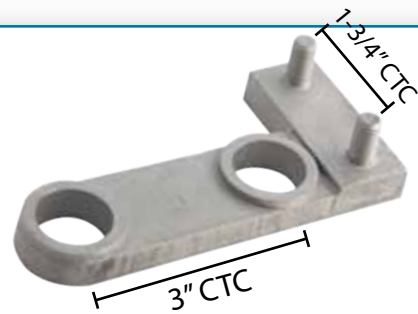

Part Number: 030-11-01
Description: Right 3" with 3/8-16 Bolts(2)
1-3/4" Center to Center

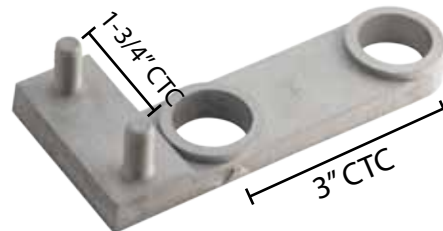

Part Number: 135-18-01
Description: Left 3-3/4" with 3/8-16 Bolts(2)
1" Center to Center

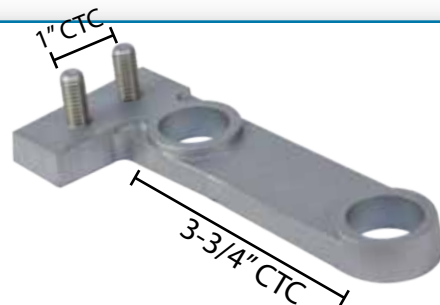

Part Number: 136-18-01
Description: Right 3-3/4" with 3/8-16 Bolts(2)
1" Center to Center

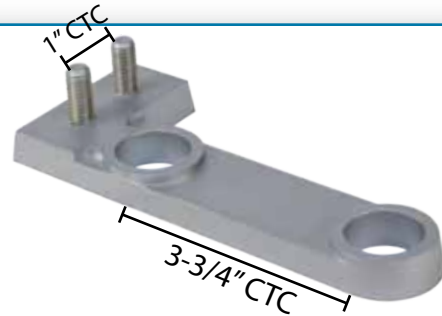

Part Number: 027-11-01
Description: Left 3-3/4" with 3/8-16 Bolts(2)
1-3/4" Center to Center

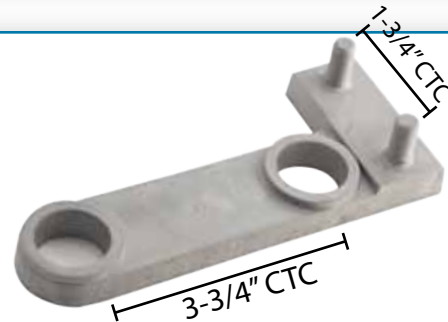

Part Number: 029-11-01
Description: Right 3-3/4" with 3/8-16 Bolts(2)
1-3/4" Center to Center

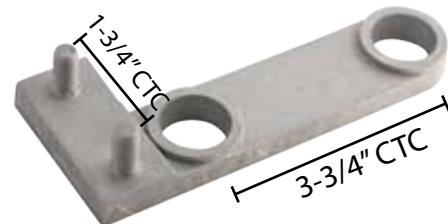

Part Number: 115-16-01
Description: Leadhead Single Post Negative Cone



Part Number: 116-16-01

Description: Leadhead Single Post Positive Cone



Part Number: 117-16-01

Description: Leadhead 3" Double Post Negative Cone



Part Number: 118-16-01

Description: Leadhead 3" Double Post Positive Cone



Part Number: 119-16-01

Description: Leadhead 3-3/4" Double
Post Negative Cone



Part Number: 120-16-01
Description: Leadhead 3-3/4" Double
Post Positive Cone



Part Number: 031-11-01
Description: Lead Burning Stick 20 oz.



INDUSTRIAL LEAD HEAD CABLE ASSEMBLIES FOR MOTIVE POWER AND MATERIAL HANDLING EQUIPMENT

Features

- Porosity free lead head for better conductivity and longer life
- Standard 1" post hole
- Flexible fine stranded copper welding cable hot tinned for maximum bond to lead head
- Color coded for polarity identification
- Shrink tubing applied to each termination for protection from moisture and corrosion
- Cable assemblies customized to your specifications (Length, Gauge, Terminations)



Straight



Offset



3-3/4" CTC



3" CTC



136 E. Walker Street • Milwaukee, WI 53204
414.672.1940 • Fax: 414.672.3533
www.terminalcastings.com